

## fermacell™ Board Knife

fermacell™ Board Knife is a tool with a hooked blade for scoring and snapping fermacell® gypsum fibreboards.

### Applications

fermacell™ Board Knife is a hand tool for cutting fermacell® gypsum fibreboards. The knife produces a V-cut and with downward pressure allows the board to be easily snapped to the required size.

### Properties

- Hardened Steel - tungsten tip
- Easy to use - smooth and easy scoring of fermacell® gypsum fibreboards
- Off Cuts - you must install the boards with a 5 - 7 mm gap at joints



### Cutting

- Ensure safe working height and mark the dimensions for cutting
- Use a straight edge as a guide to score along, and repeat scoring if needed
- Snap the scored section of the board downwards

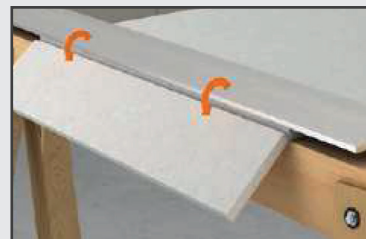

For system and application details please also refer to the fermacell® Orange Book

**Fermacell UK,  
Divison of James Hardie Building  
Products Ltd**  
7 The Priory  
Old London Rd  
Sutton Coldfield B75 5SH

**Technical support**  
Tel 0121 311 3480  
E-mail [info@jameshardie.co.uk](mailto:info@jameshardie.co.uk)  
Web [www.fermacell.co.uk](http://www.fermacell.co.uk)

#### Material Properties

Grip	anti-slip plastic
Blade	rigid with hardened metal tip
Dimensions	150 × 40 × 15 mm

#### Distributor Information

Article no.	79015
EAN	4007548001649
Tariff schedule no.	90172039
Volume / Box	6
Weight / Piece	approx. 50 g
Weight / Box	approx. 400 g

#### Additional information

Our recommendations are based on a large scale of tests and practical experiences. They do not replace guidelines, standards, approvals or technical instructions. Due to local conditions it is recommended to do a preliminary test area first.